

**BRISTOL**  
**ER9410-CBOX**  
STEP LIGHTS

PROJECT



**DESCRIPTION**

Die cast wet location back box compatible with the ER7110 and ER9410.

**SPECIFICATION DETAILS**

<b>Fixture Dimensions</b>	W9" x H3" x E4-1/8"
<b>Location</b>	Wet

\* For custom options, consult factory for details.

\* For warranty information, please visit [www.kuzcolighting.com/warranty](http://www.kuzcolighting.com/warranty)

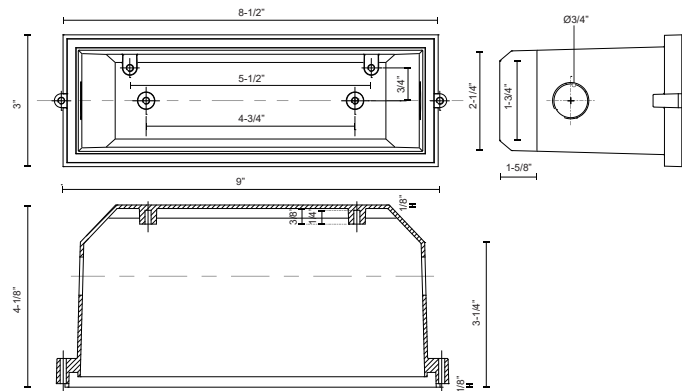

**KUZCO**

CANADA: 19054 28TH AVENUE - SURREY, BC V3Z 6M3  
USA: 3035 E. LONE MOUNTAIN ROAD - LAS VEGAS, NV 89081

[WWW.KUZCOLIGHTING.COM](http://WWW.KUZCOLIGHTING.COM)

© 2017 KUZCO LIGHTING. ALL RIGHTS RESERVED.

**COMMENT**

