

LED Exterior Pendants

EP7718
INSTALLATION SHEET

START FROM HERE

- Make sure power is completely off at the fuse box.
- Have your fixture installed by a qualified licensed electrician
- Prepare everything in a clear area.
- Wear gloves at all times during this installation.
- Read instructions carefully before you start assembly.
- Keep this instruction sheet for future reference.

Technical Support: 1-855-855-8926

Please Note:

- This Kuzco LED fixture comes with pre-wired LED module(s)
- Unless instructed, Do Not touch any part of the LED module(s) as any unnecessary contact with the module could cause permanent damage
- For dimming, an ELV (Electronic Low Voltage) or TRIAC type of dimmer is required
- Must be installed on a covered ceiling.
- 120V input

1. Remove the fixture from its original packaging. Remove the mounting plate (1c) from within the canopy (2a) by removing the decorative nuts (2b). Secure the mounting plate (1c) to the junction box (1a) with the screws (1e) provided in the hardware package.
2. Attach the rods (2c) to the pendant (3a) by threading in clockwise until it is secured. Make sure to fish the wires from the pendant through the rods and canopy (2a). Connect the rods and pendant to the canopy by threading clockwise. **(If the input wires from the driver are too long, please shorten accordingly as an option).** Connect the wires from the LED to the wires from the DC Driver (black -from LED and black -from driver)(white -from LED and white -from driver) using the marrettes (2d) provided in the hardware package. (See Illustration 1 and 2)
3. You are now ready to mount the canopy (2a) to the mounting plate (1c). First connect all wires correctly G ground to ground (from the canopy), N neutral wire (white to white), L live wire (black to black) with provided marrettes (1b) from the hardware package (See Illustration 2). Align the holes in the canopy (2a) to the threaded screws (1d) hanging downward from the mounting plate (1c). Push the canopy (2a) up towards the ceiling so the two screws (1d) clears through the hole in the canopy (2a). You can now screw on the decorative nuts (2b) onto the threaded studs pointing through the canopy to securely connect the canopy to the mounting plate.
4. You have now completed the installation of your fixture, enjoy.

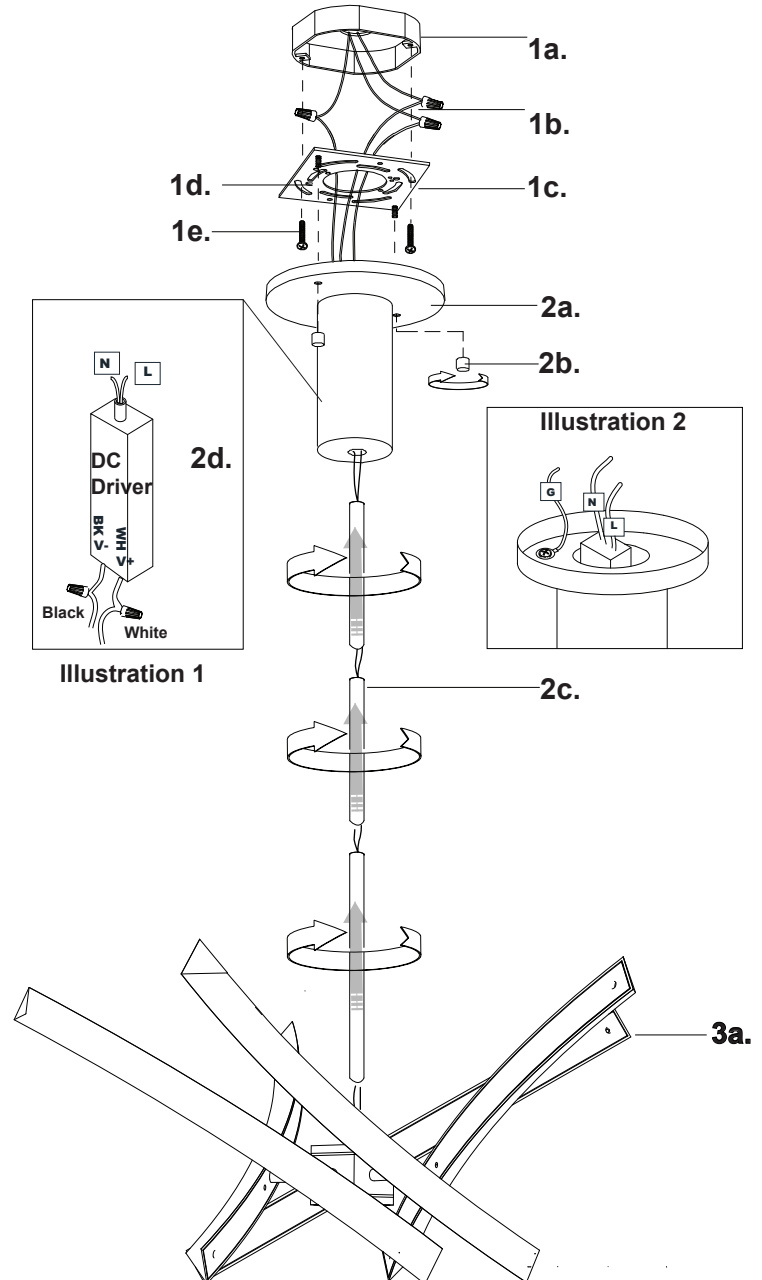

Parts Listing for Hardware Kit

No.	Description	QTY
1.	Round Head Screw 8-32x1"	2
2.	Marrette	3

Fixture Weight: 8 lb

KUZCO

19054 28th Avenue Surrey, BC Canada V3Z 6M3
T: 604 538 7162 TF: 1-855 85 KUZCO F: 604 538 7196
W: kuzcolighting.com
20180725