

START FROM HERE

- Make sure **POWER** is **COMPLETELY OFF** at the fuse box
- Have your fixture installed by a qualified licensed electrician
- Prepare everything in a clear area
- Wear gloves at all time during this installation
- Read instructions carefully before you start assembly
- Keep this installation sheet for future reference

Technical Support: 1-855-855-8926

- 1.** Remove the fixture from its original packaging. Remove the mounting plate (**1b**) from within the canopy (**2a**) by removing the two nuts (**2b**). Attach the mounting plate to the electrical junction box (**1a**) using the two screws (**1d**) provided in the hardware package.
- 2.** First connect all wires correctly G ground to ground, N neutral wire (white to white), L live wire (black to black) with provided marettes (**1e**) from the hardware package. Align the canopy (**2a**) to the treaded studs (**1c**) and screw in the two nuts (**2b**) provided to secure the canopy (**2a**) to the mounting plate (**1c**).
- 3.** Install the proper lightbulb by turning in clockwise until it is secured. (do not over tighten)
- 4.** Align the holes on the sides of the inner glass (**2c**) to the ears of the canopy (**2a**) and use the two socket screws (**2e**) to secure the glass onto the canopy. Repeat this step with the outer glass (**2d**) using the normal screws (**2f**).
- 5.** You have now completed the installation of your fixture, enjoy.

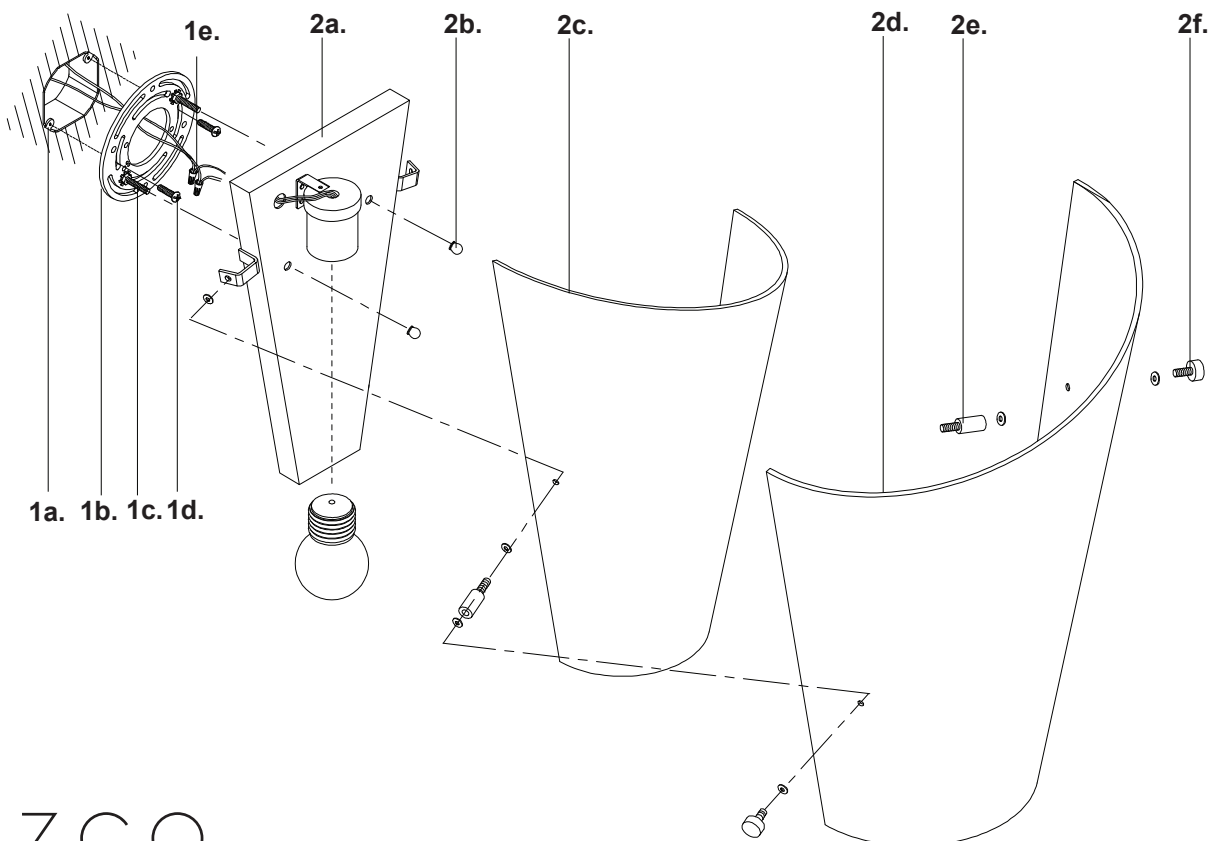

KUZCO

19054 28th Avenue Surrey, BC Canada V3Z 6M3
T: 604 538 7162 TF: 1-855 85 KUZCO F: 604 538 7196
W: kuzcolighting.com
20181127